

CASHIER AL WALL UPTO 7' HT.
 MANAGER AL WALL UPTO 5' HT.

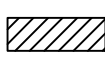

ALL WALL UPTO ROOF

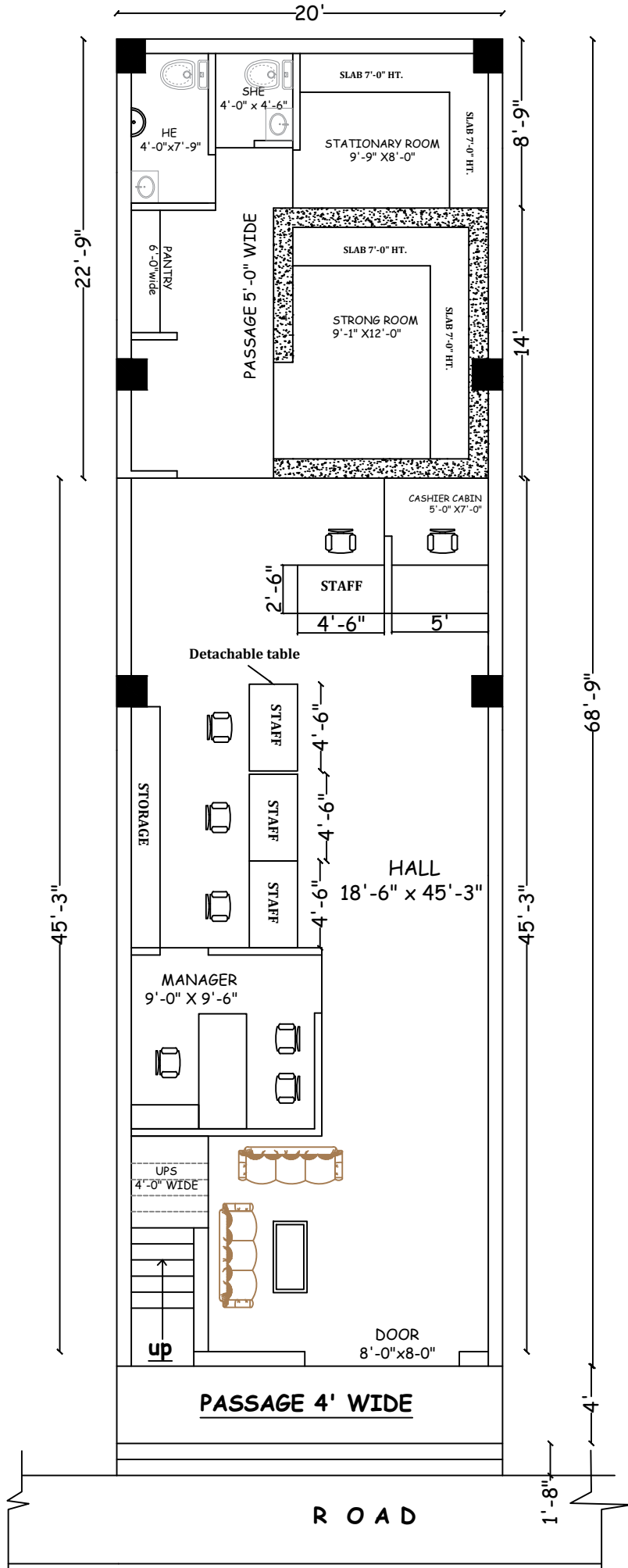

AR. B. K. SINGHAL
 98153-29429

DRAWN BY-
 ER. AMAN.

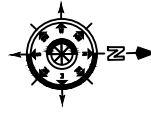

NORTH

OPTION- C
 08.01.2025

COVERED AREA= 1375 SQFT.
CARPET AREA= 1110 SQFT.

PROPOSED BRANCH
PUNJAB GRAMIN BANK
B.O. MUDDKI, FIROZPUR