

NORTH

21'

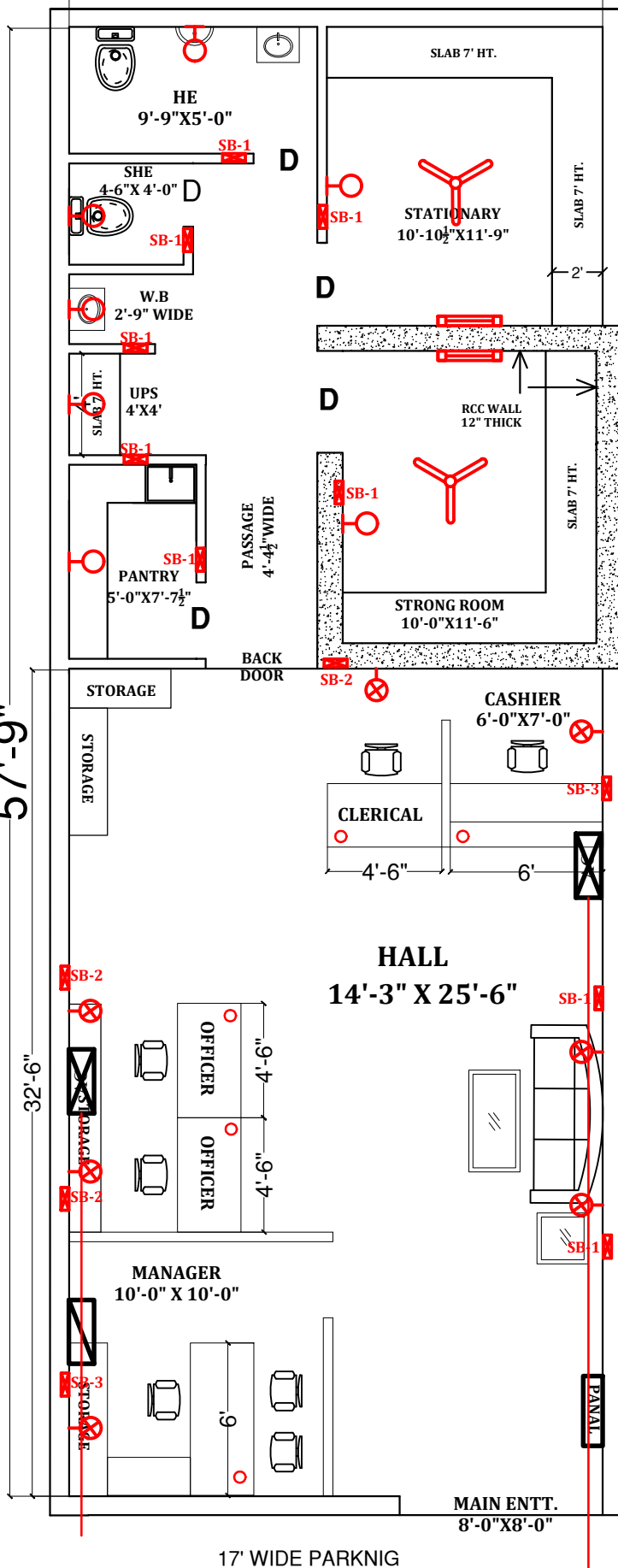

ELECTRICAL DETAIL

- SB-1 = 3"X3" = 4' HT.
- SB-2 = 8"X6" = 4' HT.
- SB-3 = 8"X6" = 3' HT.
- SB-4 = 5"X3" = 4' HT.
- AC Point = 7' HT.

	Switch Board
	Wall Fan
	Ceiling Fan
	Tube Light
	C.F.L. Light

EAST

SOUTH

PUNJAB GRAMIN BANK
B.O. BANWALA
HANUWANTA
OPTION-B

ELECTRICAL DRAWING

ER. Aman
M. 85588-46327
AR. B. K. SINGHAL
M. 98153-29429